

SCOTT

4 in 1 Hot & Cold Milk Frother - MILKISSIMO 20300

Instruction Manual



IMPORTANT INFORMATION

For safety purpose you should read the instructions carefully before using the appliance for the first time. Save the instructions for future reference.



The appliance is designed for domestic use and may only be operated in accordance with these instructions for use.

Danger: The appliance can cause injuries if it is misused.

DO's

1. Check the rating of the appliance and make sure it corresponds to local mains supply.
2. Ensure all packaging materials are removed from the appliance before the first use.
3. Place and use the appliance on a dry, flat and stable surface.
4. This appliance is not intended for use by persons (including children) with reduced physical, sensory or mental capabilities, or lack of experience and knowledge, unless they have been given supervision or instruction concerning use of the appliance by a person responsible for their safety.
5. Always use the handle on the milk jug when using this appliance.
6. Always cover the milk jug firmly with the lid before operation, as hot contents may overflow during operation.
7. Turn the power off and remove the plug when the appliance is not in use and before cleaning.
8. Never leave the appliance unattended while in use.
9. If the power cord is damaged, it must be replaced by the manufacturer or its service agent or similarly qualified person in order to avoid any hazard.
10. This appliance is intended for household and domestic use only.
11. The plastic bags used to wrap this appliance or the packaging may be dangerous. To avoid risk of suffocation, keep these bags out of reach of babies and children. These bags are not toys.

DO NOT's

1. Do not use or place the appliance on a wet or hot surface, near hot ovens, electric and gas burners.
 2. Do not use an extension power cord set unless competent authority has approved it.
 3. Do not leave the cord hanging over the edge of a kitchen table, work top or touch hot surfaces.
 4. Do not let children play with the appliance.
 5. To protect against fire, electric shock and injury, do not immerse the appliance, power cord or plug in water or other liquids.
 6. Do not use the appliance for any purpose other than its intended use.
 7. Do not put the appliance in dishwasher.
 8. Do not cover the appliance when in use.
 9. Do not operate the appliance when the milk jug is empty.
 10. Do not touch the heating element surface during or after operation as this may result in burning.
 11. Do not insert foreign objects such as knives or forks into the milk jug during operation.
 12. Do not unplug the appliance by pulling the power cord from the mains supply.
 13. Do not operate the appliance if the power cord or plug has been damaged or if the appliance malfunctions or is damaged in any way. Contact the service agent when in doubt.
 14. Do not use any accessories or attachments with this appliance other than those recommended by SCOTT.
- 
- 

GENERAL DESCRIPTION

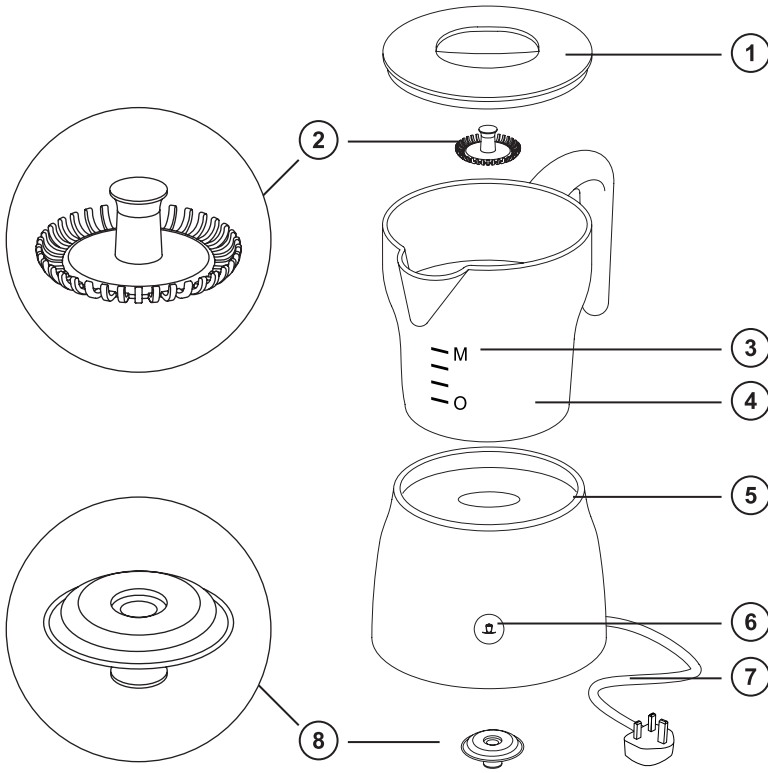

- 1. Lid
- 2. Frothing whisk
- 3. Level marks
- 4. Milk jug

- 5. Power base
- 6. Operating key
- 7. Power cord with plug
- 8. Heating whisk

TECHNICAL SPECIFICATION

- Input: 230V ~ 50Hz
- Power: 600W
- Heating element: Flat heating disc
- Capacity: Max. 200ml for hot/cold frothing and 250ml for heating milk
- Cord length: 0.75m
- Dimensions (L x H x W): 16.8 x 18.8 x 12.6cm

OPERATION PROGRAMME

Beverage	Light indicator	Instruction	Milk level	Recommendation
Hot milk foam	Red	Press once	Max. 200ml	Cappuccino
Cold milk foam	Blue	Press three times	Max. 200ml	Café latte
Hot milk	White	Press twice	Max. 250ml	Hot chocolate

PREPARING HOT / COLD MILK FOAM

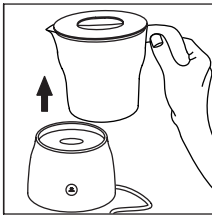

Figure 1

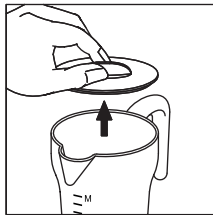

Figure 2

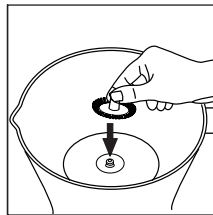

Figure 3

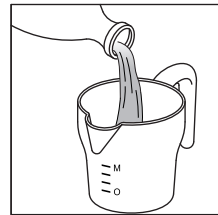

Figure 4

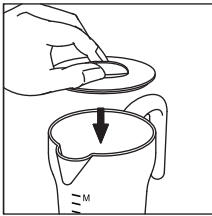

Figure 5

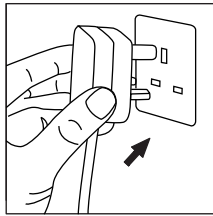

Figure 6

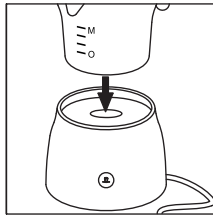

Figure 7

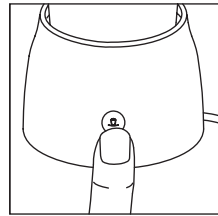

Figure 8

Steps:

1. Remove the milk jug from the power base. (Figure 1)
2. Open the lid of the milk jug. (Figure 2)
3. Insert the frothing whisk into the whisk holder inside the milk jug. It will click into place audibly. (Figure 3)
4. Add 200ml of milk to the milk jug. (Figure 4)

Note: If milk is filled above the "M" mark, it will overflow during operation.

Note: Always add sufficient milk to at least the "O" mark for proper operation.

5. Cover the milk jug firmly with the lid. (Figure 5)
6. Insert the plug into a suitable wall socket. (Figure 6)
7. Place the milk jug on the heating element of the power base. (Figure 7)
8. Press the operating key to select the following (Figure 8):
 Hot milk foam: Press the key once and the ☺ symbol lights up in red.
 Cold milk foam: Press the key three times and the ☺ symbol lights up in blue.
9. The symbol flashes and lights steady when the appliance is ready. The appliance then starts frothing the milk automatically.
10. The appliance stops automatically as soon as the process is finished. (About 1 to 4 minutes depending on the volume of milk.) There will be a signal tone and the symbol will go out. You can pour out or spoon out the froth.

Note: The ☺ symbol will keep lighting up during operation and will go out when the milk frothing process is completed.

Note: You can interrupt the process at any time. Simply press the operating key and the appliance will stop immediately.

Note: It takes approximately 4 minutes for the appliance to cool down after frothing and heating milk and before it can operate again.

PREPARING HOT MILK / HOT BEVERAGES

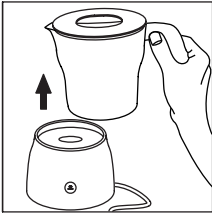

Figure 9

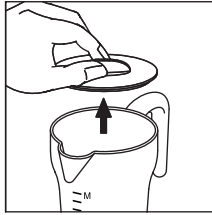

Figure 10

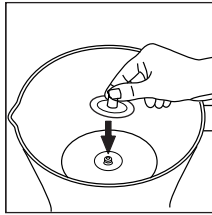

Figure 11

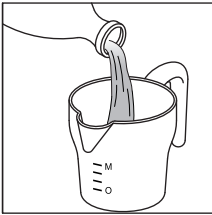

Figure 12

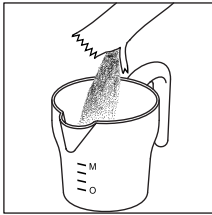

Figure 13

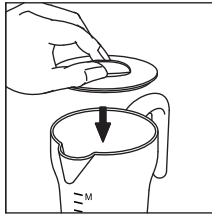

Figure 14

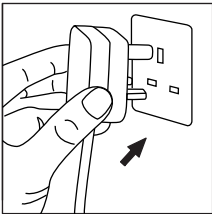

Figure 15

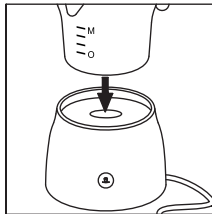

Figure 16

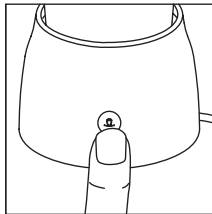

Figure 17

Steps:

1. Remove the milk jug from the power base. (Figure 9)
2. Open the lid of the milk jug. (Figure 10)
3. Insert the heating whisk into the whisk holder inside the milk jug. It will click into place audibly. (Figure 11)
4. Add 250ml of milk into the milk jug, i.e. up to "M" mark of the level marks. (Figure 12)

Note: If milk is filled above the "M" mark, it will overflow during operation.

Note: Always add sufficient milk to at least the "O" mark for proper operation.

5. If you wish to create frothy hot chocolate, add a maximum of 50g of chocolate powder or chocolate chip into the milk jug. (Figure 13)
6. Cover the milk jug firmly with the lid. (Figure 14)
7. Insert the plug into a suitable wall socket. (Figure 15)
8. Place the milk jug on the heating element of the power base. (Figure 16)

9. Press the operating key twice and the  symbol lights up in white (Figure 17). The symbol flashes and lights steady when the appliance is ready. The appliance then starts heating the milk automatically.
10. The appliance stops automatically as soon as the process is finished. (About 5 to 7 minutes depending on the volume of milk.) There will be a signal tone and the symbol will go out. You can pour out the hot chocolate.

Note: The  symbol will keep lighting up during operation and will go out when the milk frothing process is completed.

Note: You can interrupt the process at any time. Simply press the operating key and the appliance will stop immediately.

Note: It takes approximately 4 minutes for the appliance to cool down after frothing and heating milk and before it can operate again.

CLEANING INSTRUCTION**Cleaning the milk jug and whisks**

1. Empty the milk jug, disconnect the appliance from the power and allow the appliance to cool down before cleaning.
2. Remove whisk inside the milk jug. Flush away and clean the inner walls of the milk jug with warm soapy water and a non-abrasive sponge or brush. Wipe with a dry cloth.

Note: Be careful while cleaning the outer base of the milk jug. Avoid scratches on the surface where the heating element has contact.

Note: Do not use any solvents or abrasive agents for cleaning.

Note: Do not use sharp or hard instruments such as steel wool for cleaning.

Cleaning the power base in case of spillage

1. Switch off the power and remove the plug before cleaning the outer surface of the power base.
2. Use a damp cloth gently wipe spillage from power base. Ensure to dry off the appliance before plugging into the power outlet.

Note: Do not put any part of the appliance in the dishwasher.

Note: Do not immerse the power base in water or any other liquid, or allow moisture to come into contact with these parts. (Figures 18 & 19)

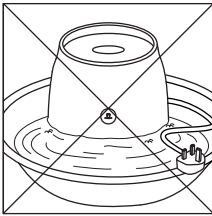

Figure 18

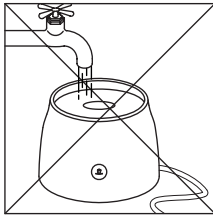

Figure 19

RECYCLING YOUR ELECTRICALS



At the end of the electrical products useful life, it should not be disposed with household waste. Please arrange to take the appliance to recycling points set up around the country.

To find out more information about the recycling of electrical items and the recycling point, please visit www.recycle-more.co.uk .

SCOTT (UK) Limited
Unit 1, The iO Centre,
Fingle Drive, Stonebridge,
Milton Keynes,
MK13 0AT,
United Kingdom.



